

How to Join the WSAMA Google Groups Listserv

Create your Google Login

Sign into Google.com. There are two options for signing in:

1. Sign in with an existing Gmail account. See image 1. (or create a new Gmail account).

Or

2. Register using your work, city, or any non-Gmail address. For this option:

A) Select **Create Account**.

B) Select **For Myself**. See image 2.

Image: 1

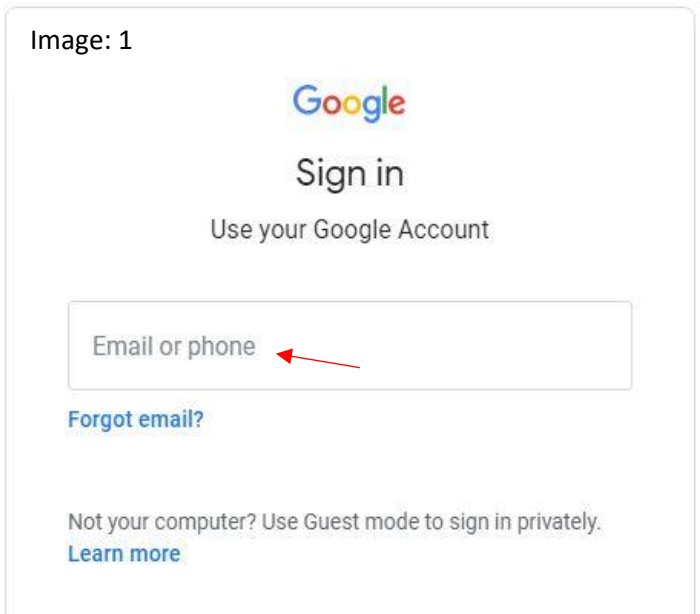
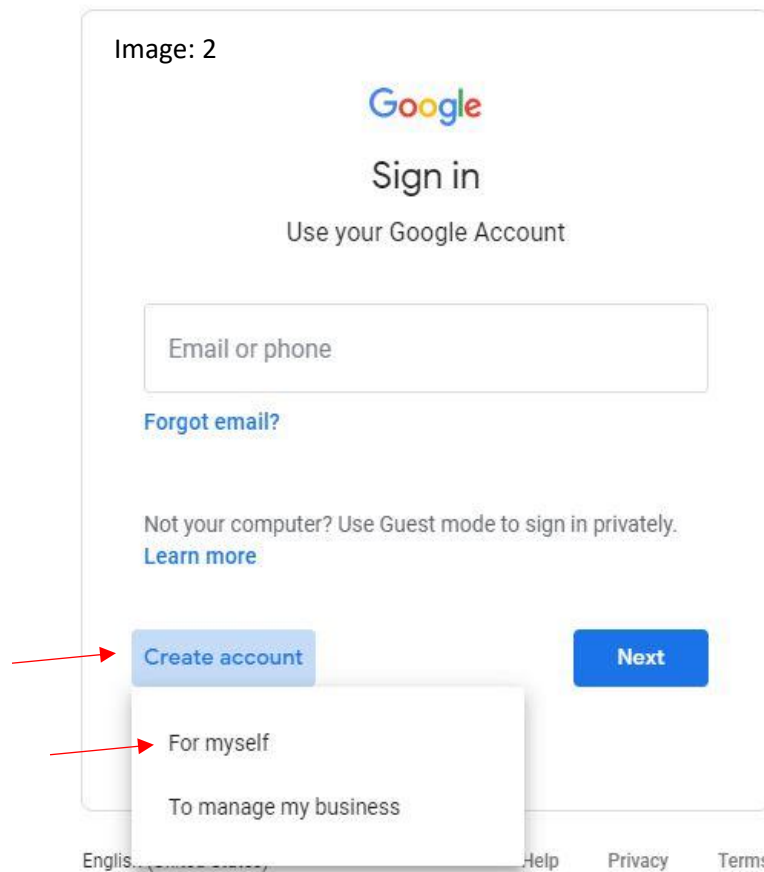

Image: 2



C) Select **Use my current email address instead**. See image 3.

D) Enter your information including the email address where you'd like to receive notifications and messages from the WSAMA listserv. See image 4.

Image: 3

Google

Create your Google Account

First name Last name

Username @gmail.com

You can use letters, numbers & periods

[Use my current email address instead](#)

Password Confirm

Use 8 or more characters with a mix of letters, numbers & symbols

[Sign in instead](#) [Next](#)

Image: 4

Google

Create your Google Account

First name Last name

Your email address

You'll need to confirm that this email belongs to you.

[Create a new Gmail address instead](#)

Password Confirm

Use 8 or more characters with a mix of letters, numbers & symbols

[Sign in instead](#) [Next](#)

E) Follow the steps to verify your account. An email and text verification is required. See image 5a and 5b.

Image: 5a

Google

Verify your email address

Enter the verification code we sent to
JOHN_DOE@city.gov If you don't see it, check your spam

Enter code

[Back](#) [Verify](#)

Image: 5b

Google

Verify your phone number

To make sure this number is yours, Google will send you a text message with a 6-digit verification code. *Standard rates apply*

(555) 555-5555

Enter verification code

[Back](#) [Verify](#)

[Call instead](#)

Join WSAMA Google Group

1. From your web browser, go to: <https://groups.google.com/u/1/g/wsama?pli=1>
2. Log into Google with a Gmail account or login using your work/city email. (Instructions to login with a non-Gmail email is provided above.)

3. Once logged in, select "Ask to join this group." See image 6.

Or

Contact admin@wsama.org to receive an invitation to join the Listserv. (No login required at this point)

4. An email will be sent to your inbox with further instructions. See image 7.
5. To post messages and respond to WSAMA Google Groups, send an email to: wsama@googlegroups.com.
6. Questions? Contact admin@wsama.org.

